

Quick Start Guide

Battery-powered machine skate

Components

Instructions for models **EP5** [JLA-e 5], **EP15** [JLA-e 15], **EP25** [JLA-e 25]

Skate



Battery
Compartment



Charger
(UL Recognized)



Remote Battery
& Charger

Remote
Control



Quick Starter Guide

Start up Skate

1. Disconnect the charger.



2. Connect the cable from the skate to the battery.



3. To turn ON

- Press and hold the Sleep button (green) for 1 second until the light turns ON
- Then turn ON/OFF switch (red) from OFF to ON.

4. To shut system OFF

- Turn ON/OFF switch to OFF.
- Press Sleep button for 5 seconds until light turns off

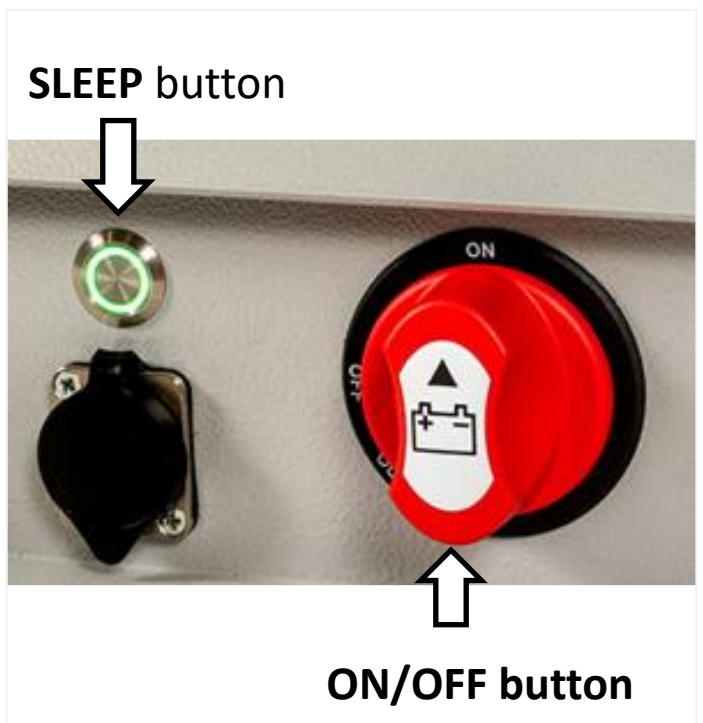

Quick Starter Guide

Sleep Function

ALERT

The SLEEP function shuts the battery OFF after 1 hour of no use to prevent battery drainage.

DO NOT leave skate under load with buttons inaccessible ! Rotate skate with buttons facing out if necessary.



Quick Starter Guide

Start up of Remote

1. Insert battery into battery compartment (bottom of remote)



2. Turn & Pull Red “Stop” button. This turns the remote ON.



3. The display on the remote will now guide you through the next steps as follows:



4. Simultaneously push the two buttons on the right. (This will activate the Wi-Fi connection with the skate).



5. The skate is still locked from movement for safety. Press the left button to unlock. The system is now ready to move.



To Shut-off, push Red “Stop” button.



Quick Starter Guide

Moving

Joysticks

Each joystick (left and right) can be pushed forward or pulled backwards. The skate's wheels (left and right) will react accordingly.

Moving the left and right joystick in opposite direction (one forward, one backwards), will cause the skate to spin in place.

The speed is controlled with the amount of tilting of each joystick.

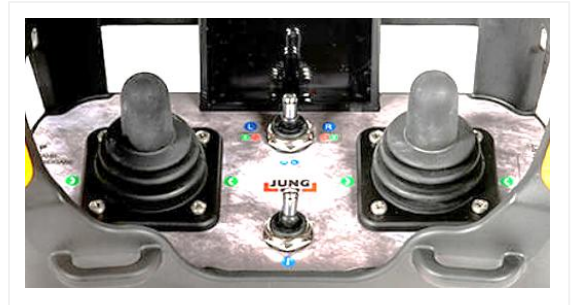

Intuitive controls.

- **Forward**
- **Backward**
- **Turn-Spin**
- **Speed**

Emergency STOP

Push the *Stop* button in to immediately shut down the system.



Note: The two switches in the center of the remote do not have any function. These are used when operating multiple skates simultaneously.



Quick Starter Guide

Charging Instructions - Dolly

1. Turn skate OFF: Turn the main switch (red) to OFF, then press and hold the Sleep button (green) until the light turns OFF

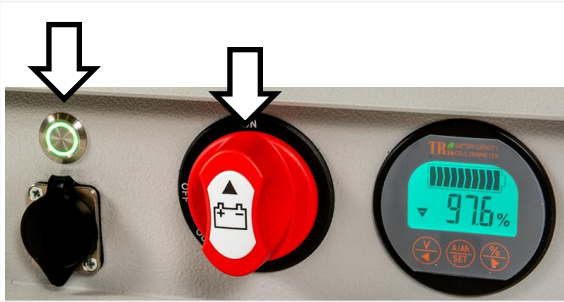

2. Disconnect the cable from the skate to the battery

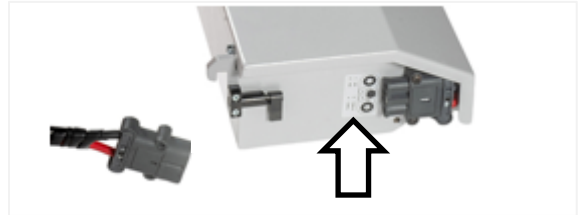

3. Connect the charger to the battery compartment and plug into a 110V Outlet.

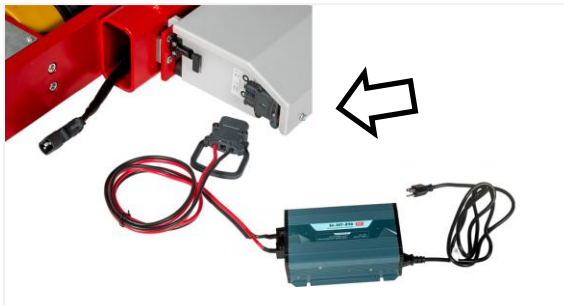

4. Turn skate back ON: Press and hold the Sleep button until the light turns ON, then turn the main switch to ON

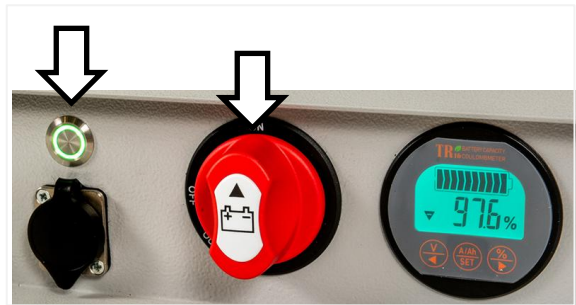

5. Turn the switch on the charger to ON



6. Indicators on battery will display state of charge

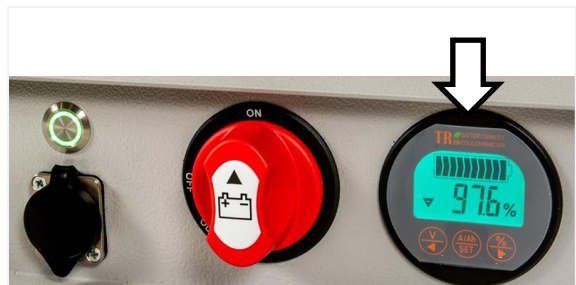

Indicators on charger



- Red: Charging | Orange: Fault
- Green: Battery is fully charged

A full charge will require approx. 4-5 hours

Quick Starter Guide

Charging Instructions - Remote Control

1. Open the battery compartment (bottom of remote control) and remove the battery



2. Insert the battery into the charger



3. Plug the charger in to a 110 V Outlet

A full charge will require approx. 3 hours.

Indicators on charger

- Red: Charging (Needs additional charge)
- Green: Fully charged



Quick Starter Guide

Battery Storage

When skate is not in use, store as follows:

1. Turn the main switch (red) to OFF, then press and hold the Sleep button (green) until the light turns OFF

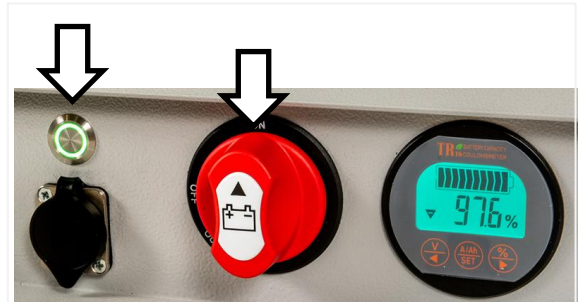

2. Disconnect the battery connector from the skate

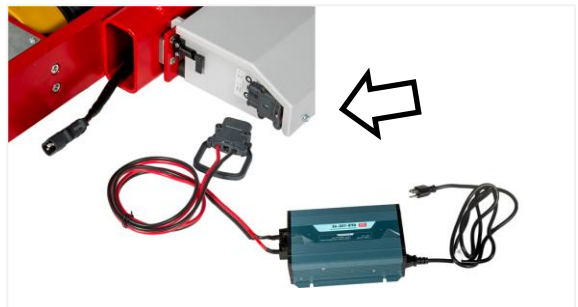

IMPORTANT: The battery must be charged once every 3 months or the batteries may suffer permanent damage.
